

Sistema Elite

Corredizas y fijas

Window World



**CATALOGO GENERAL DEL SISTEMA
CORREDIZO ELITE**

ÍNDICE

Generalidades.....	2
Configuraciones posibles.....	2
Secciones de perfiles.....	3
Ensamble:	
Sistema 2 hojas + malla / Sistema 3 carriles.....	6
Sistema 3 hojas + malla / Sistema 4 carriles.....	6
Sistema 3 hojas + malla / Sistema 3 carriles.....	7
Sistema 3 hojas + 2 mallas / Sistema 3 carriles.....	7
Sistema 4 hojas + 2 mallas / Sistema 3 carriles.....	8
Sistema 4 hojas + malla / Sistema 5 carriles.....	8
Sistema 5 hojas + 2 mallas / Sistema 4 carriles.....	9
Sistema 5 hojas + malla / Sistema 6 carriles.....	9
Sistema 6 hojas + 2 mallas / Sistema 6 carriles.....	10
Detalles de cortes de piso.....	11

GENERALIDADES DEL SISTEMA ELITE

	Mínimo	Máximo
Alto de la hoja:		3200 mm
Ancho de la hoja:		1600 mm

Dimensión del perfil de hoja:	40mm x 83mm
Dimensión del perfil de marco:	Marco adaptable: 64.4mm x 45mm Marco 3 rieles: 180mm x 45mm
Peso máximo:	200 kg
Espesor máximo de vidrio:	36 mm

CONFIGURACIONES POSIBLES

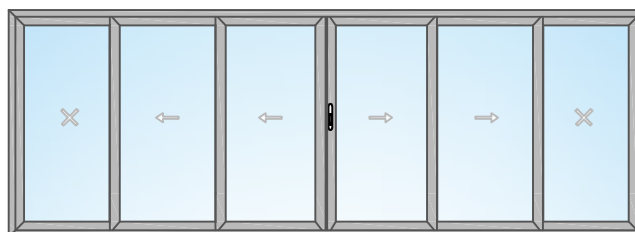
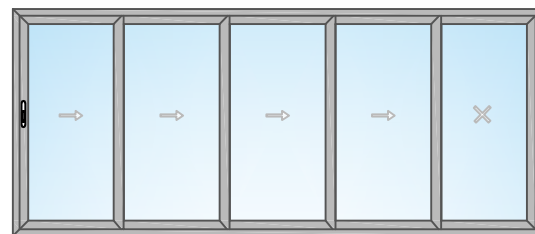
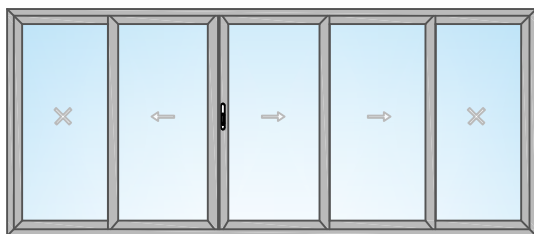
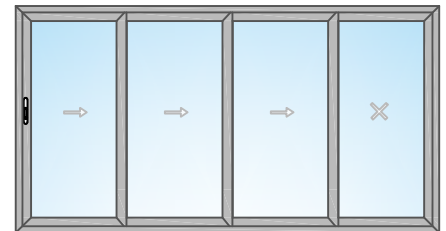
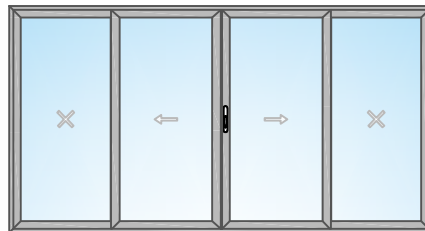
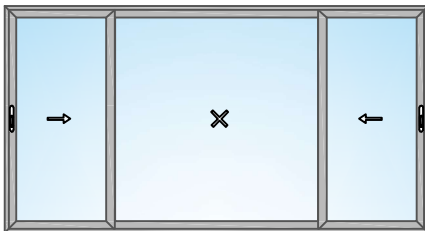
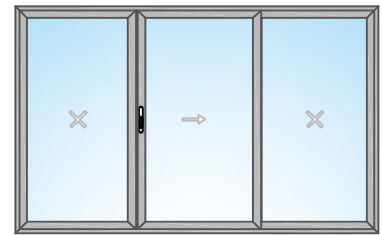
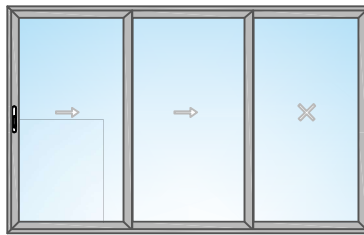
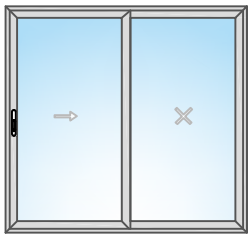

Escala 1:1

Secciones genéricas

Sección B-B'

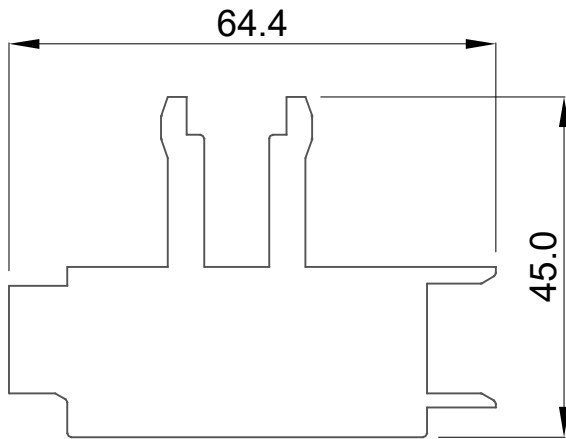

FI-5252
MARCO ADAPTABLE

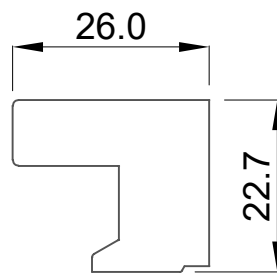

FI-4467
JUNQUILLO RECTO

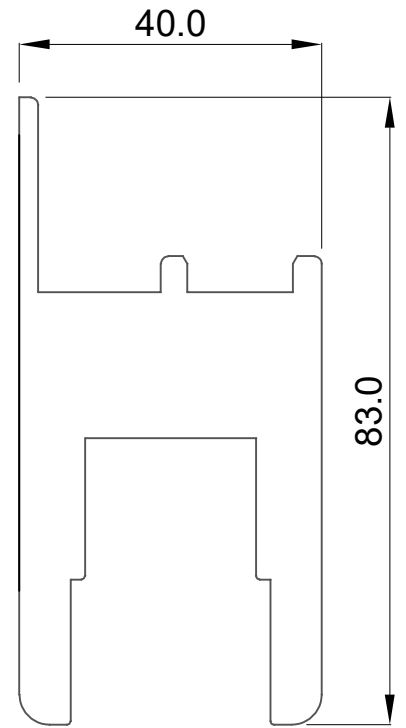

FI-5245
HOJA CORREDIZA

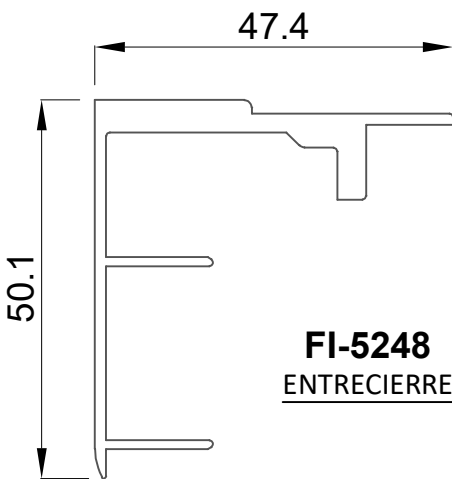

FI-5248
ENTRECIERRE

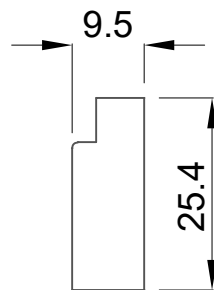

FI-277
PERFIL MALLA

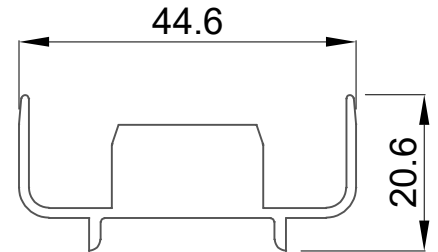

FI-5266
ADAPTADOR DE HOJA

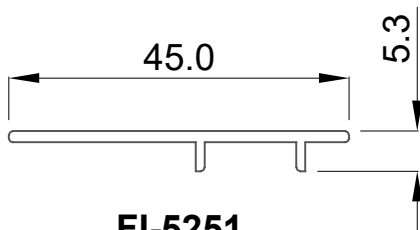

FI-5251
TAPA PARA MARCO

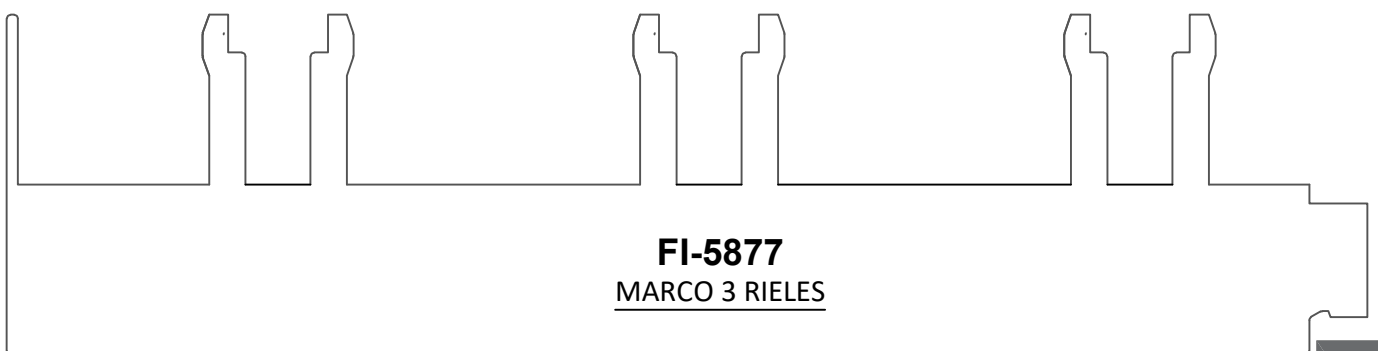

FI-5877
MARCO 3 RIELES

Escala 1:2

Secciones genéricas

Sección B-B'

Corte Vertical

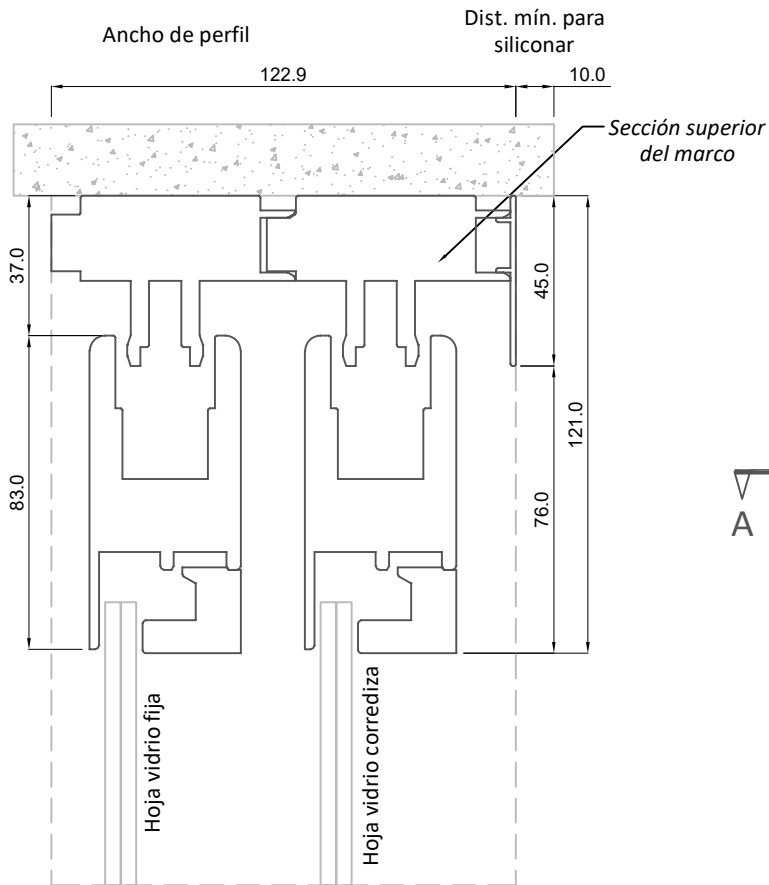

Ventana Genérica 2 Carriles: 2 hojas sin malla

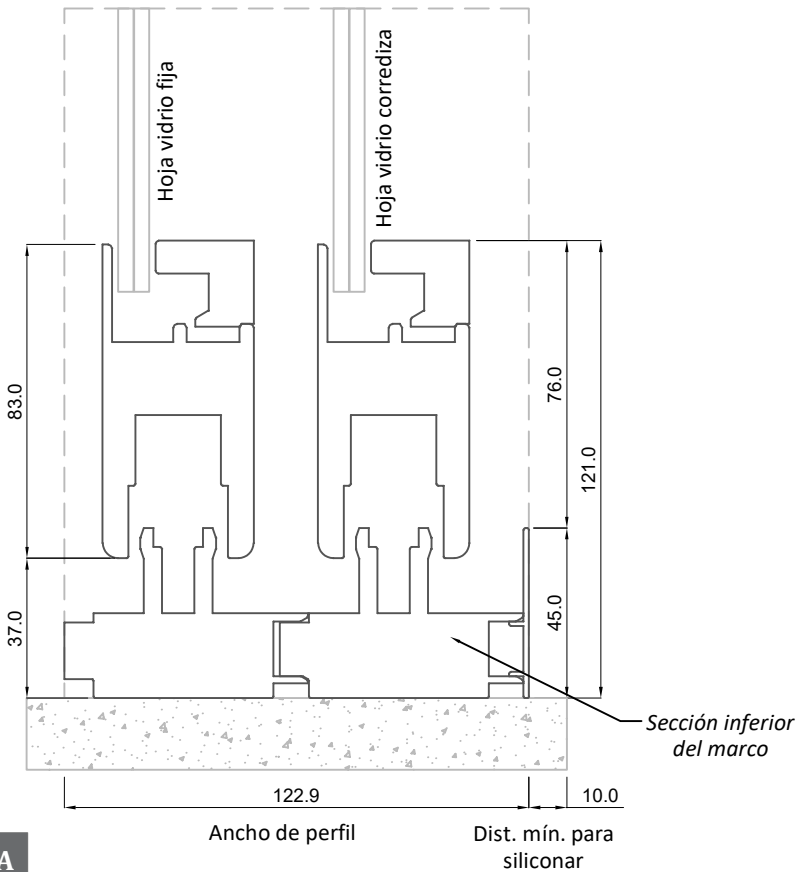
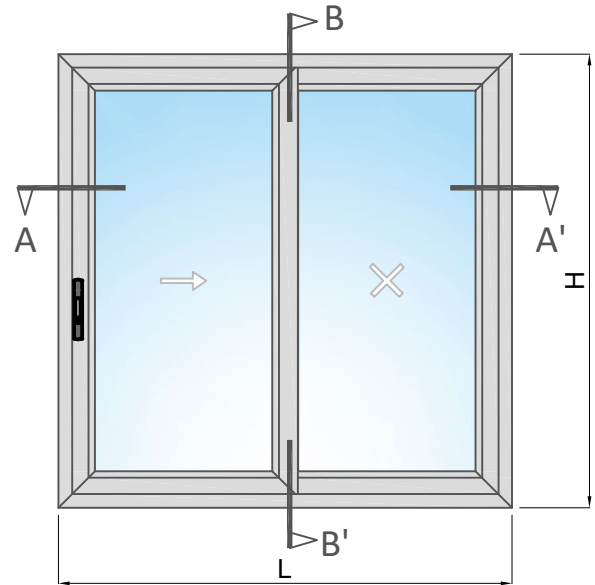

Detalle de espesor de vidrio

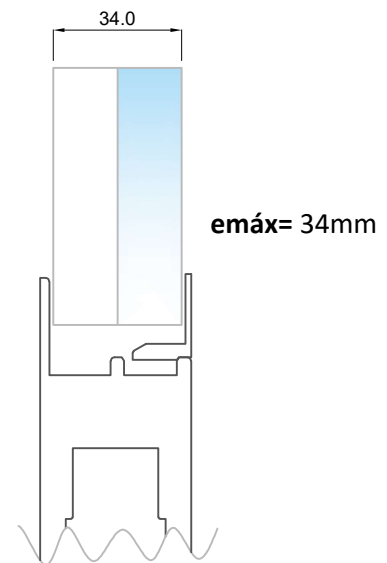

Secciones genéricas

Escala 1:2

Sección A-A'

Corte Horizontal

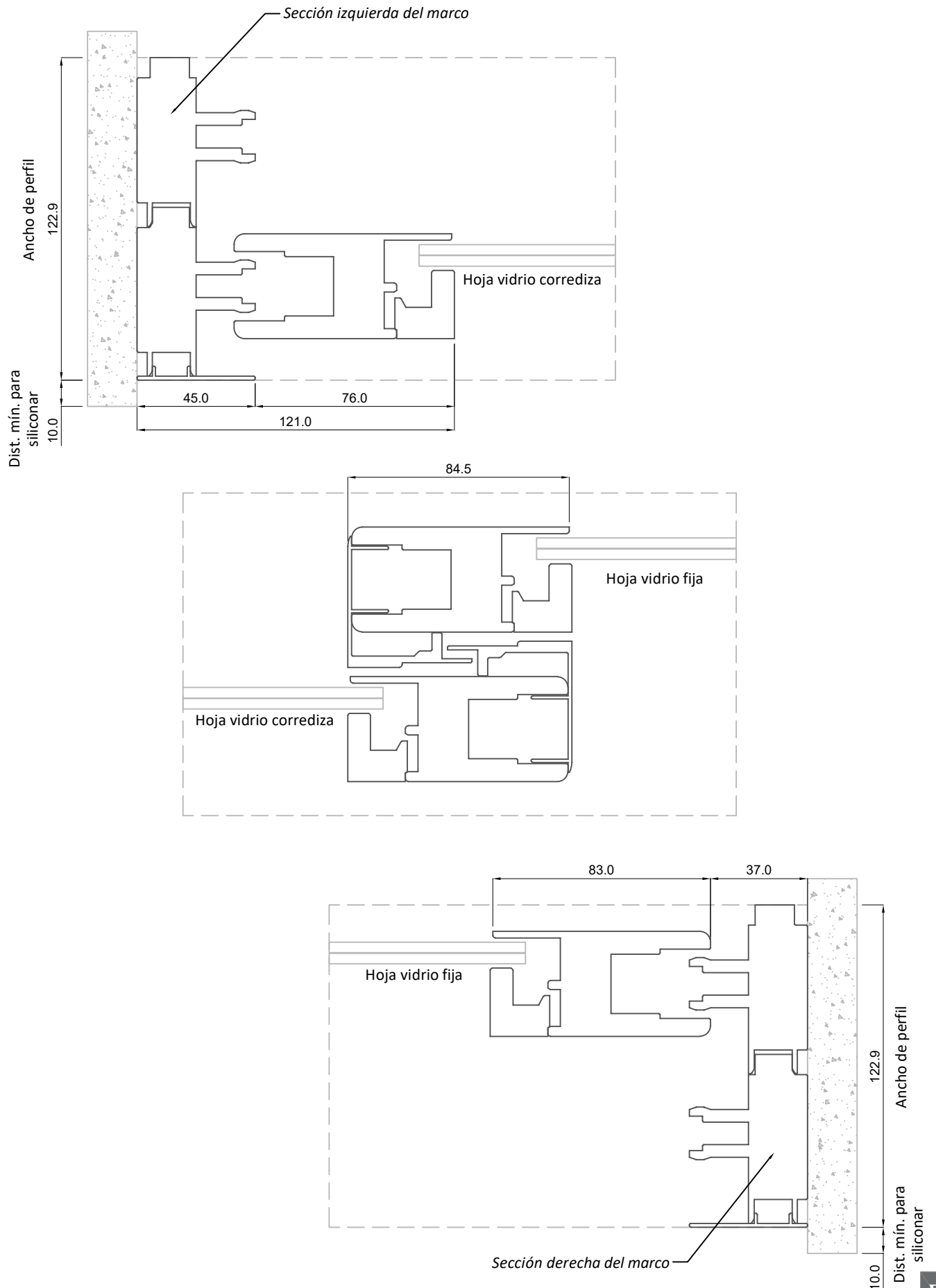

Unidades en milímetros

EL-A

05

Escala 1:6

Elite 3 carriles

Sistema 2 hojas + malla

Nota:

- La malla es opcional. Al considerarse sin malla se usaría 1 riel menos.

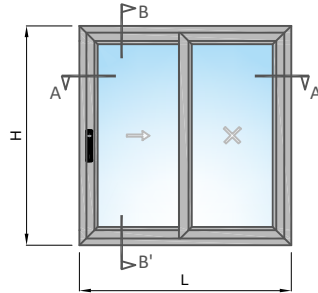

Corrediza por interior
Sección B-B'

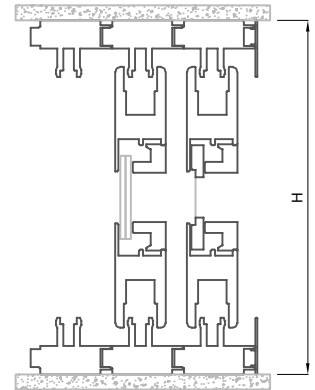

Corrediza por interior
Sección A-A'

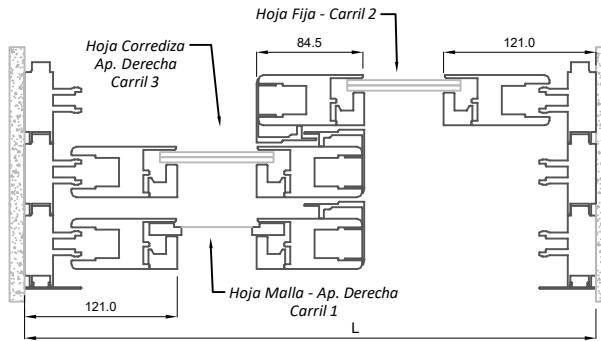

Corrediza por exterior
Sección B-B'

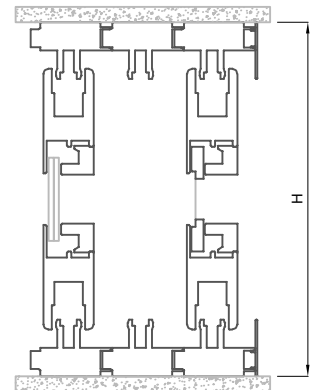

Corrediza por exterior
Sección A-A'

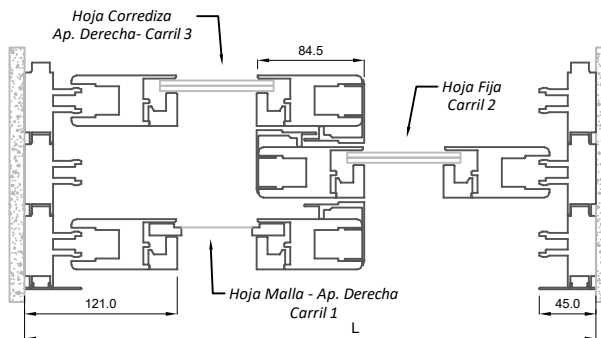

Escala 1:6

Elite 4 carriles

Sistema 3 hojas + malla

Nota:

- La malla es opcional. Al considerarse sin malla se usaría 1 riel menos.

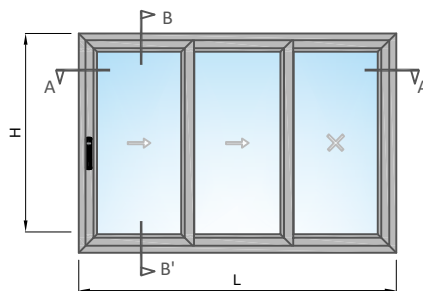

Sección B-B'

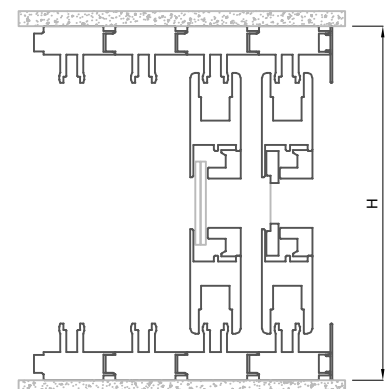

Sección A-A'

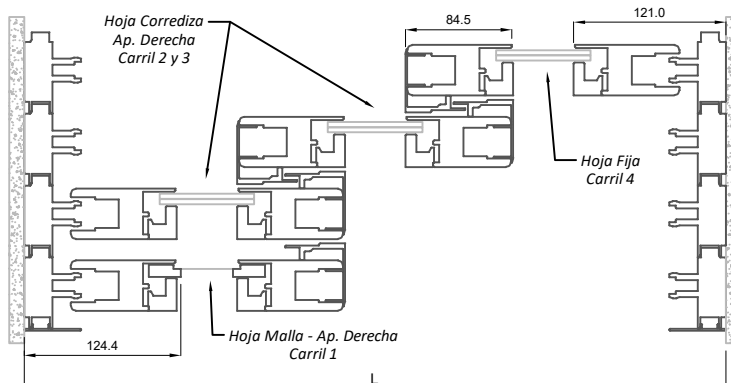

Elite 3 carriles

Escala 1:6

Sistema 3 hojas + Malla

Nota:

- La malla es opcional. Al considerarse sin malla se usaría 1 riel menos.

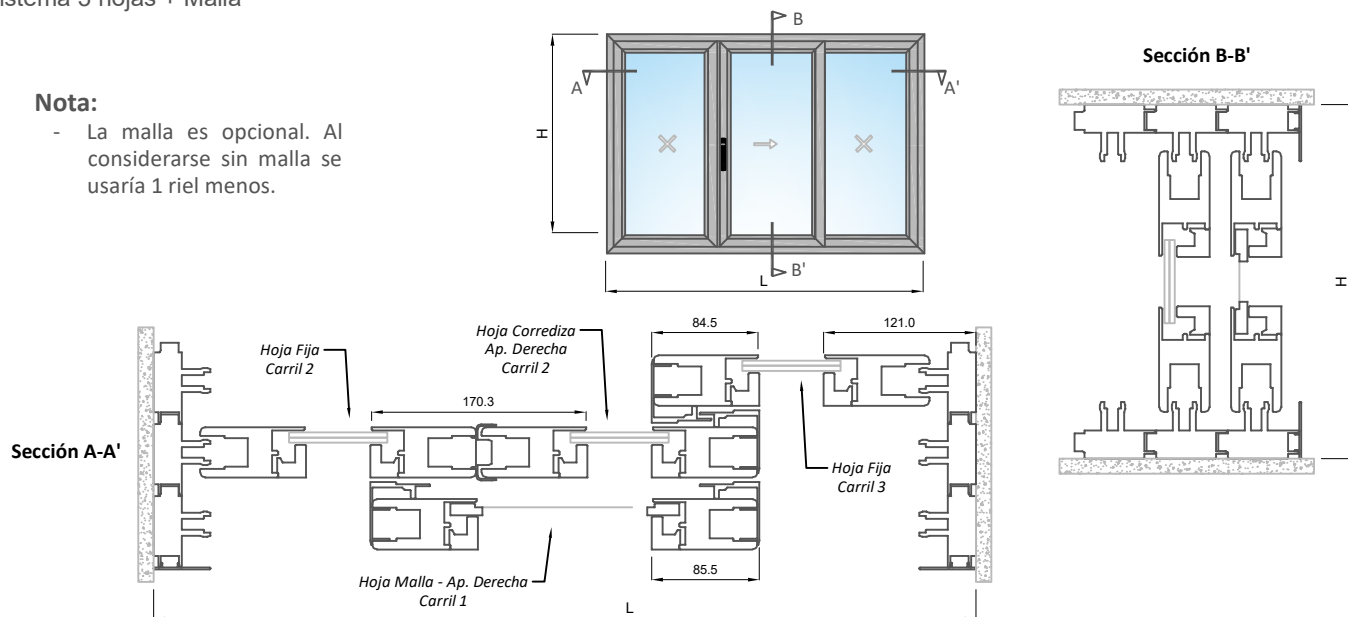

Elite 3 carriles

Escala 1:6

Sistema 3 hojas + 2 Mallas

Nota:

- La malla es opcional. Al considerarse sin malla se usaría 1 riel menos.

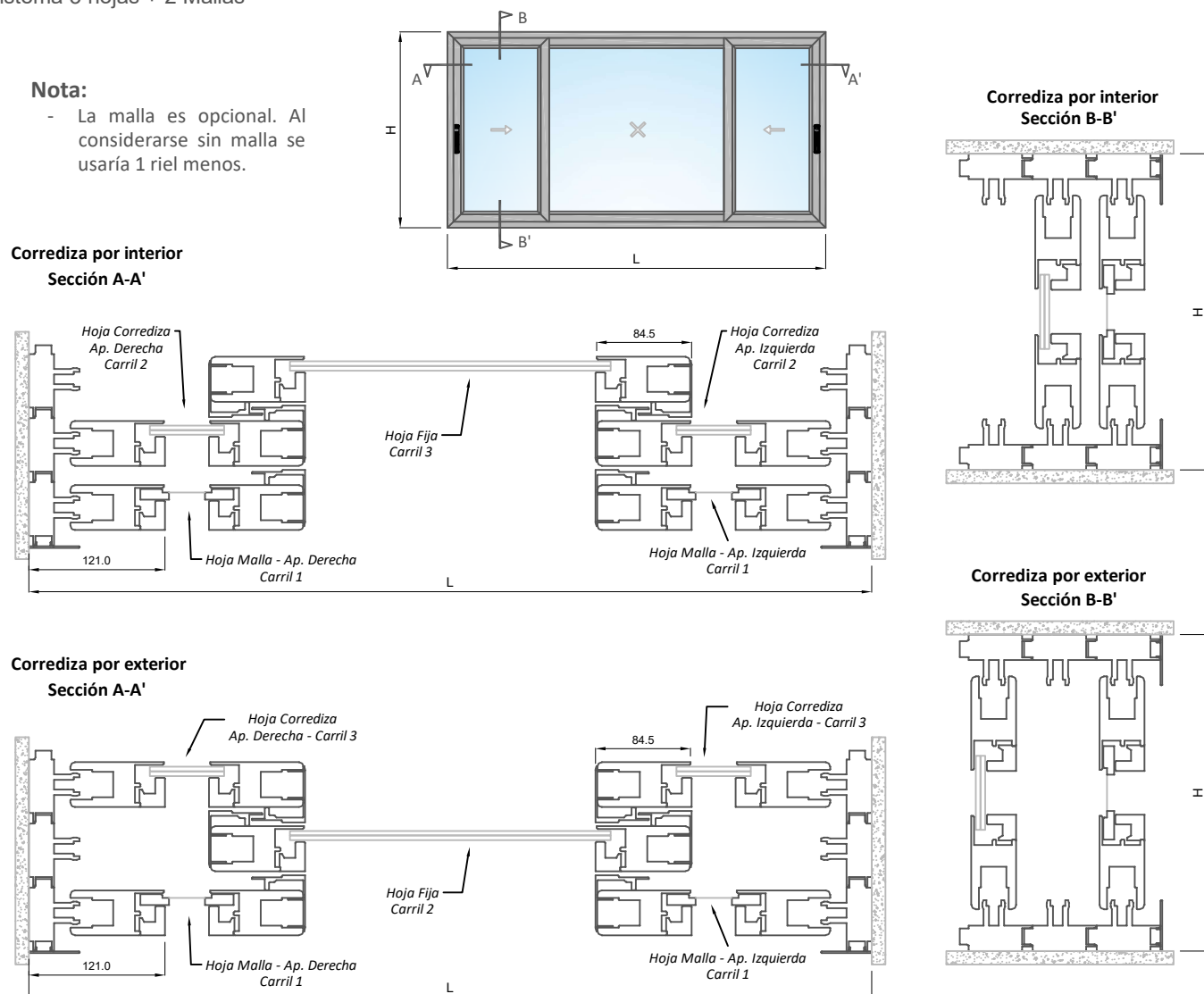

Escala 1:6

Elite 3 carriles

Sistema 4 hojas + 2 Mallas

Nota:

- La malla es opcional. Al considerarse sin malla se usaría 1 riel menos.

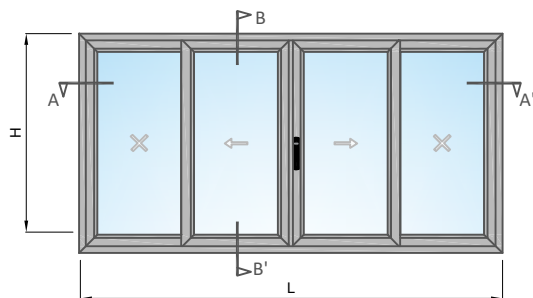

Corrediza por interior
Sección A-A'

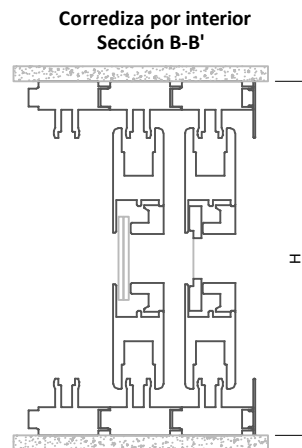
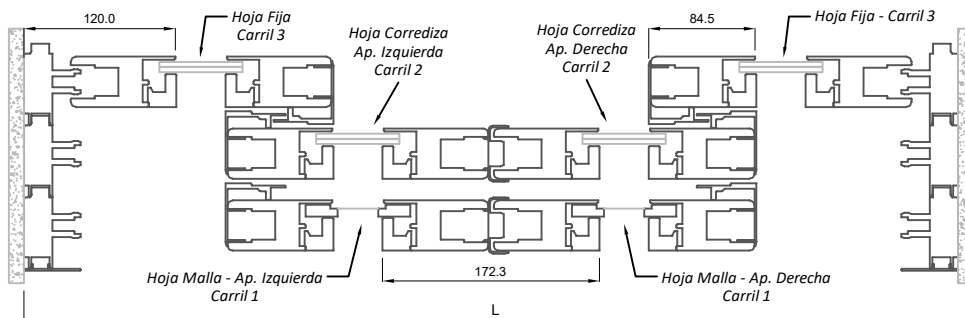

Corrediza por exterior
Sección A-A'

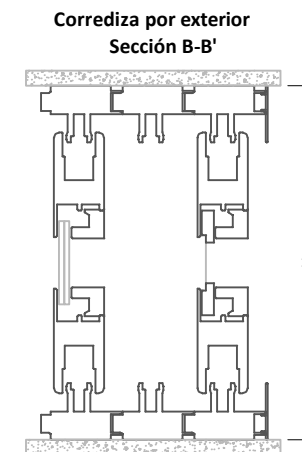
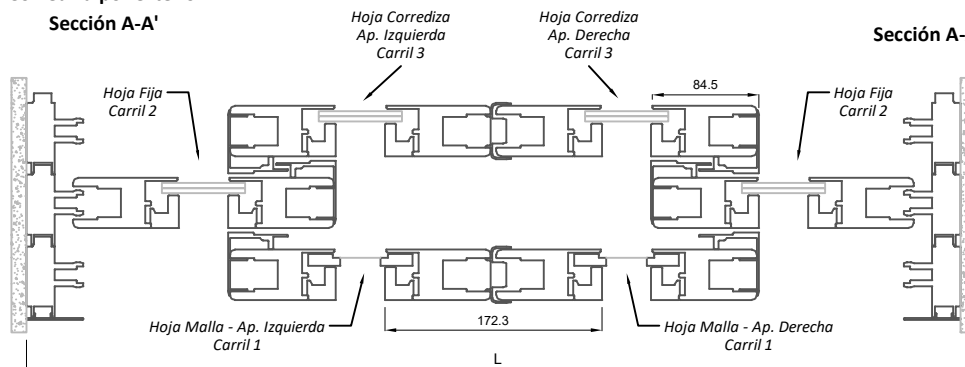

Escala 1:6

Elite 5 carriles

Sistema 4 hojas + Malla

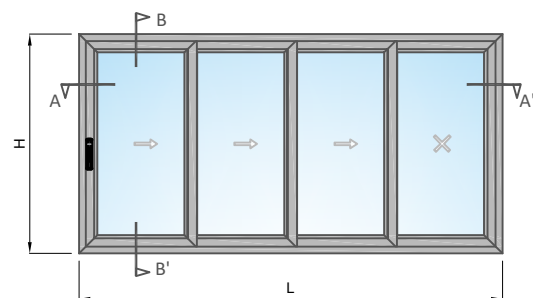

Sección A-A'

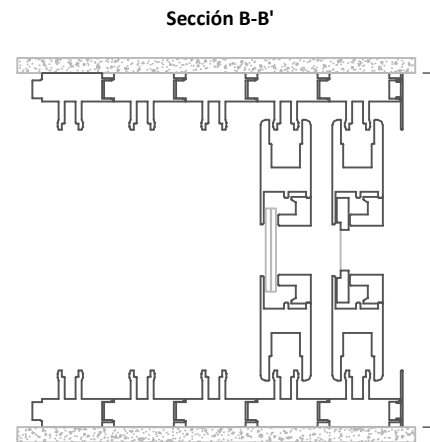
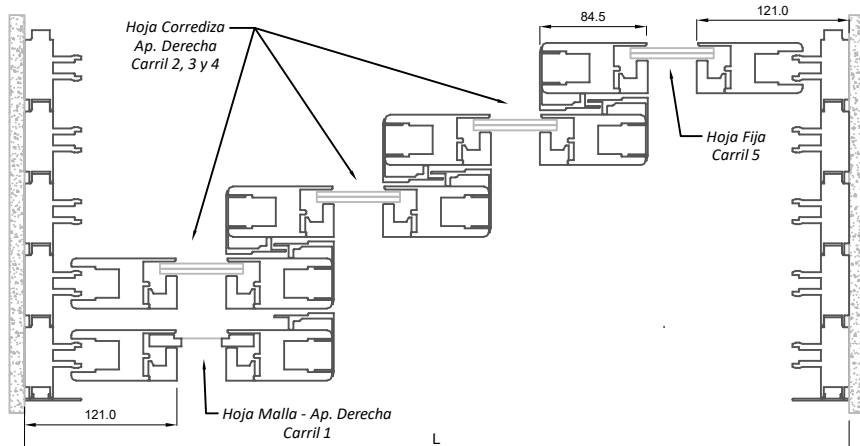

Nota:

- La malla es opcional. Al considerarse sin malla se usaría 1 riel menos.

Elite 4 carriles

Escala 1:6

Sistema 5 hojas + 2 mallas

Nota:

- La malla es opcional. Al considerarse sin malla se usaría 1 riel menos.

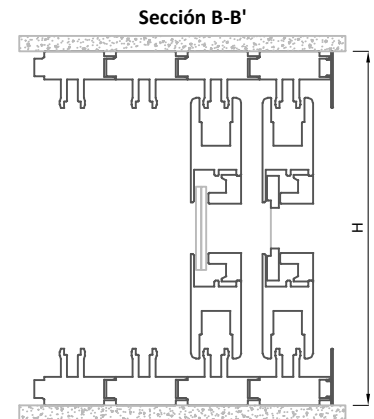
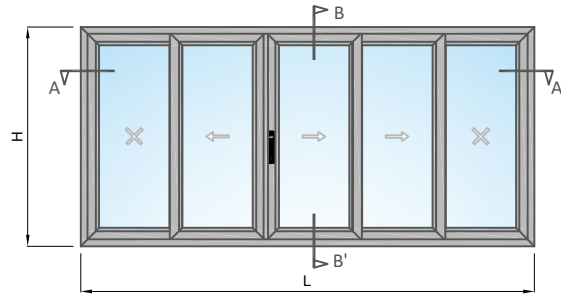

Sección A-A'

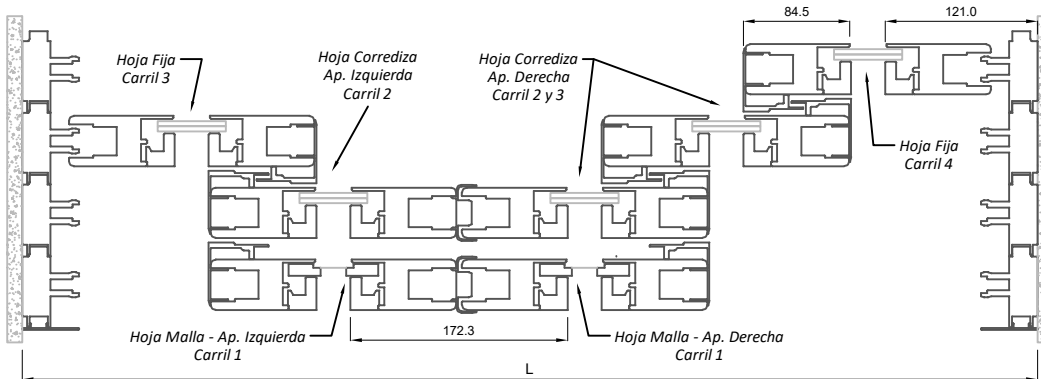

Elite 6 carriles

Escala 1:6

Sistema 5 hojas + malla

Nota:

- La malla es opcional. Al considerarse sin malla se usaría 1 riel menos.

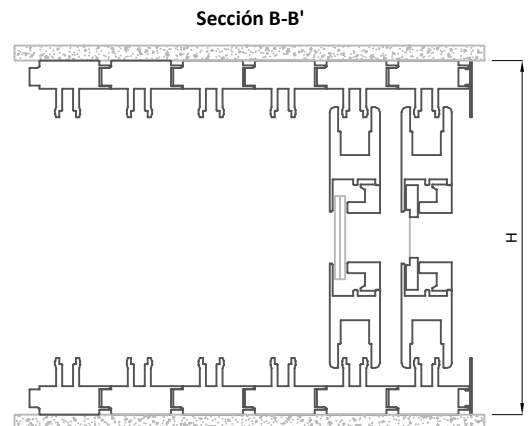
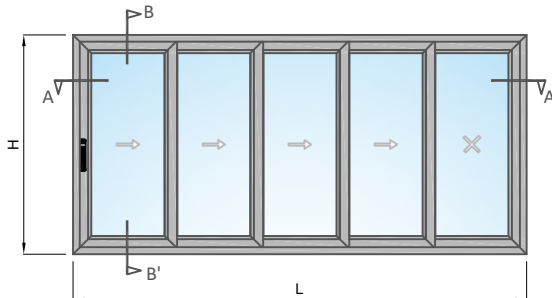

Sección A-A'

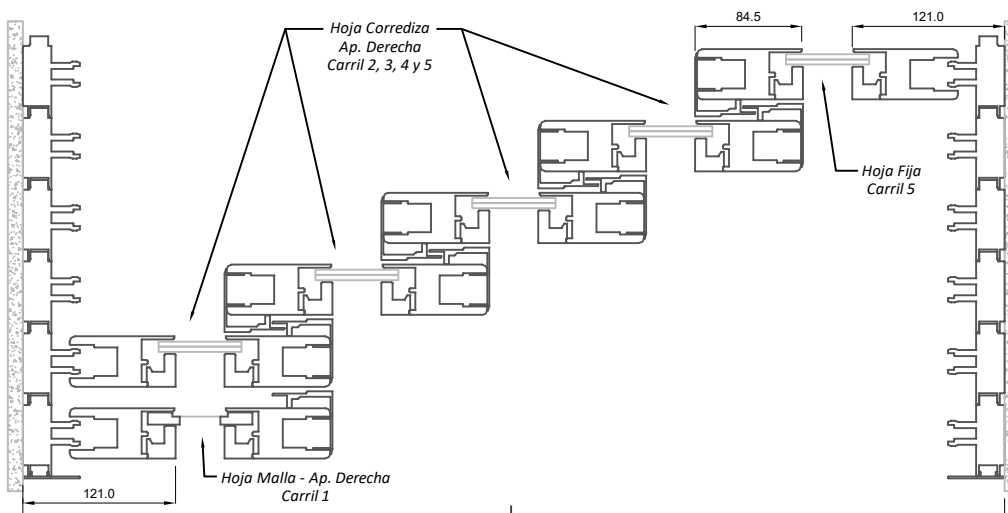

Unidades en milímetros

Escala 1:6

Elite 6 carriles

Sistema 6 hojas + 2 Mallas

Nota:

- La malla es opcional. Al considerarse sin malla se usaría 1 riel menos.

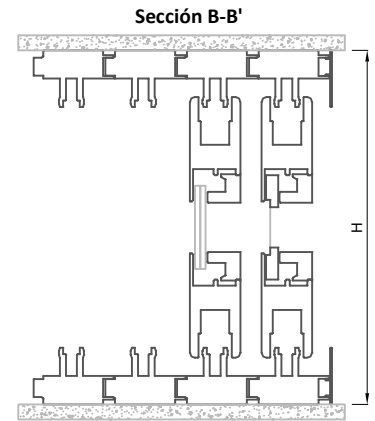
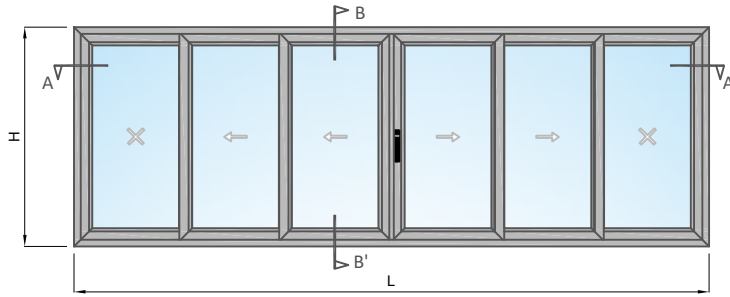

Sección A-A'

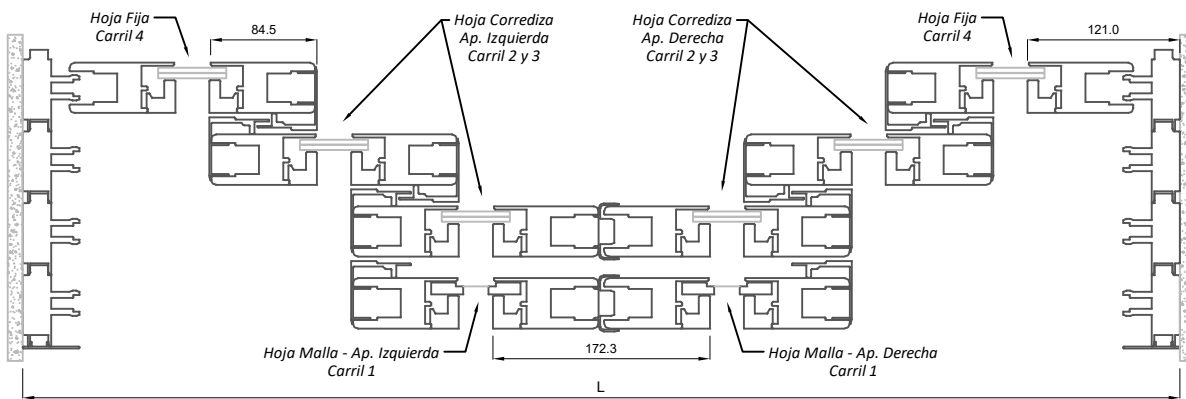

Detalles de cortes de piso

Escala 1:3

Secciones genéricas

Opción #1

ELT y MG - 2 Rieles

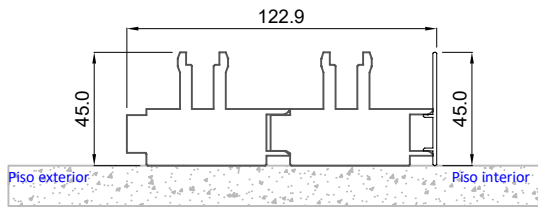

ELT y MG - 3 Rieles

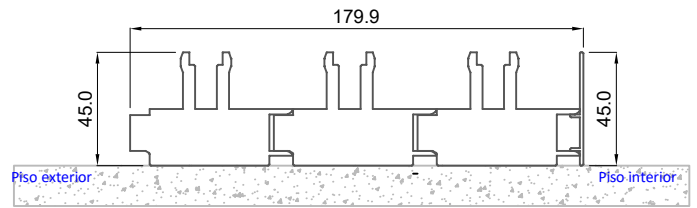

Opción #2

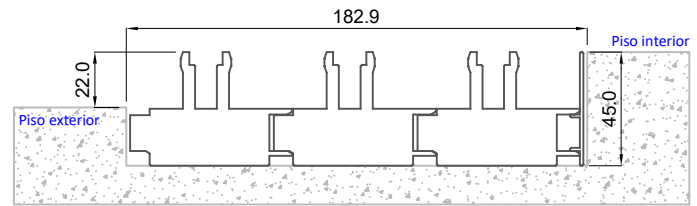
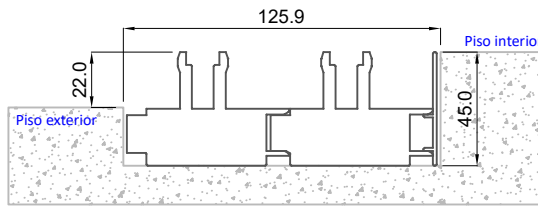

Opción #3

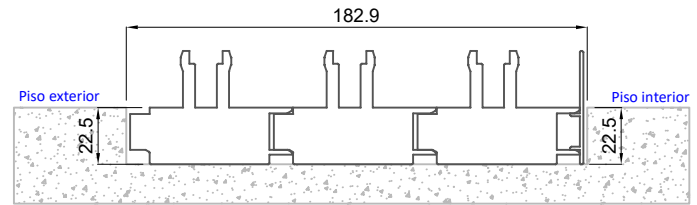
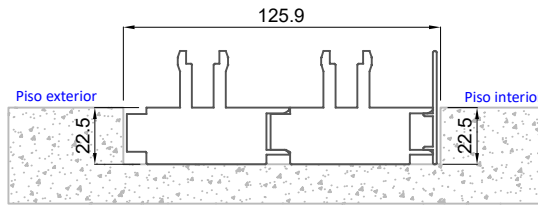

Opción #4

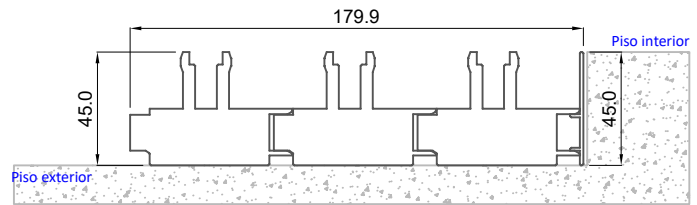
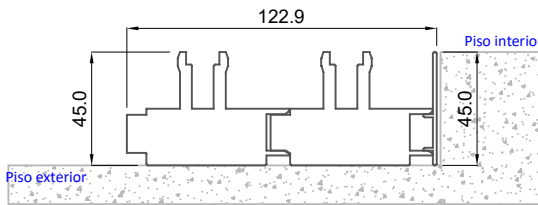

Opción #5

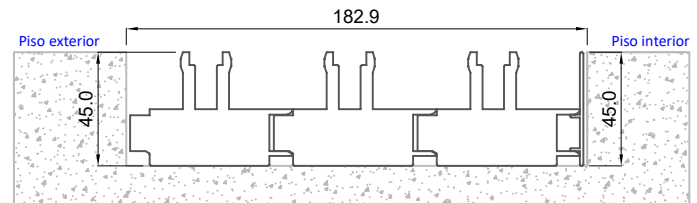
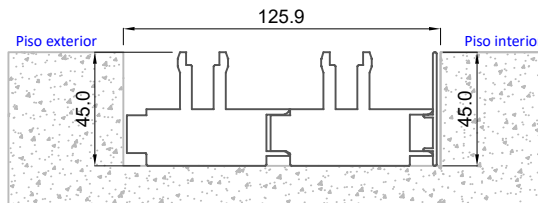

Opción #6

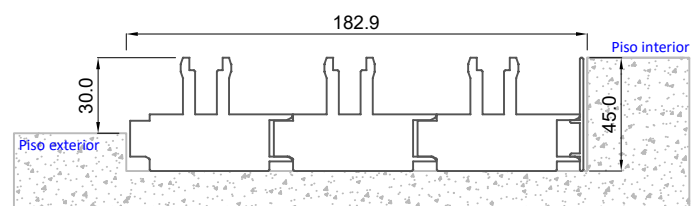
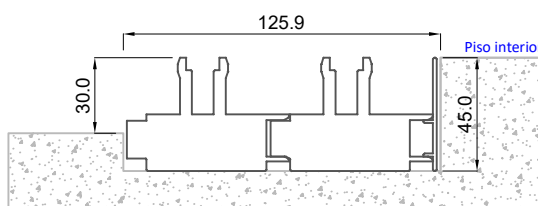

Unidades en milímetros

Detalles de cortes de piso

Escala 1:3

Secciones genéricas

ELT y MG - 4 Rieles

Opción #1

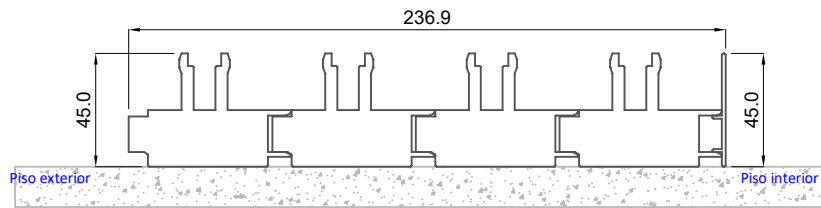

Opción #2

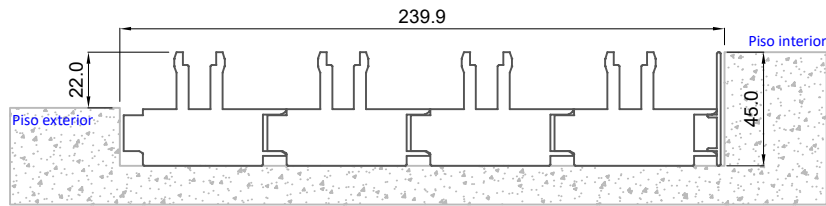

Opción #3

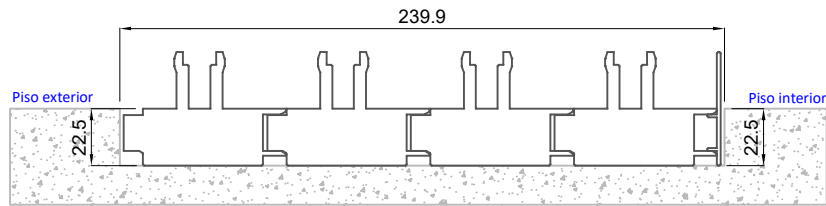

Opción #4

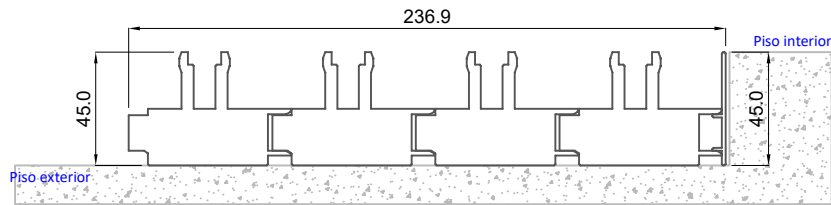

Opción #5

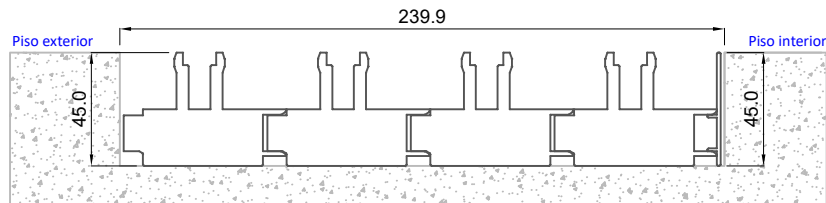

Opción #6

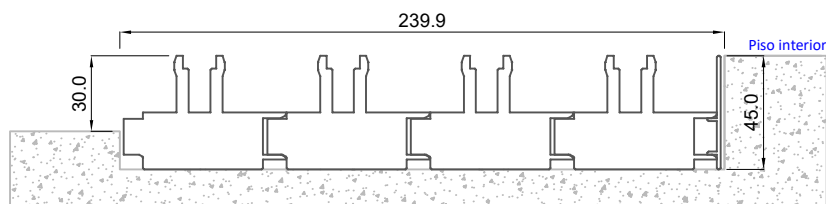

Detalles de cortes de piso

Escala 1:3

Secciones genéricas

ELT y MG - 5 Rieles

Opción #1

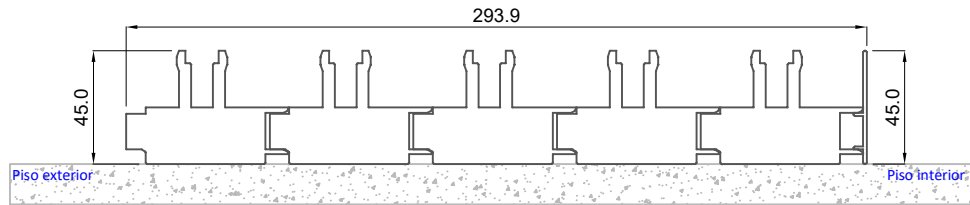

Opción #2

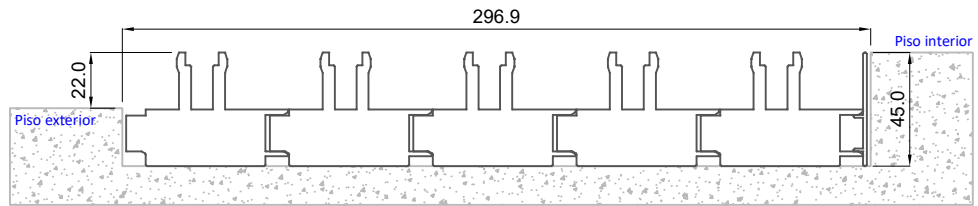

Opción #3

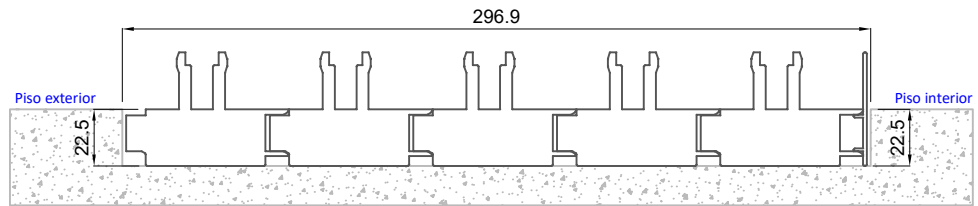

Opción #4

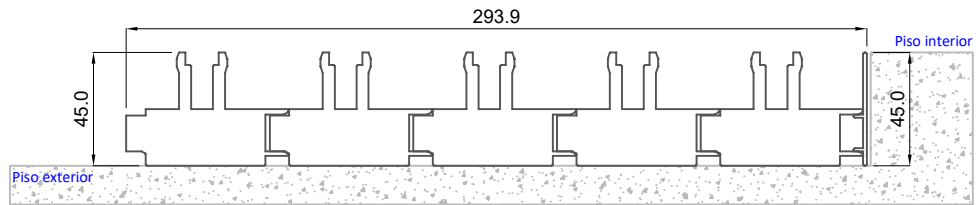

Opción #5

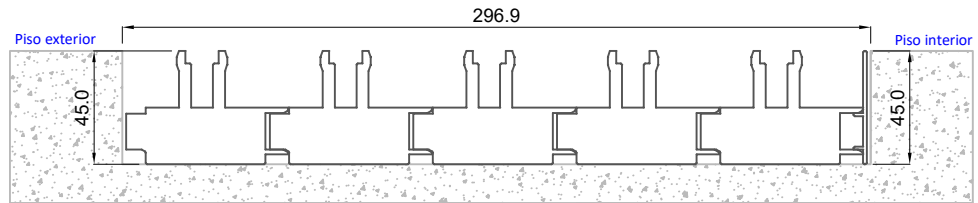

Opción #6

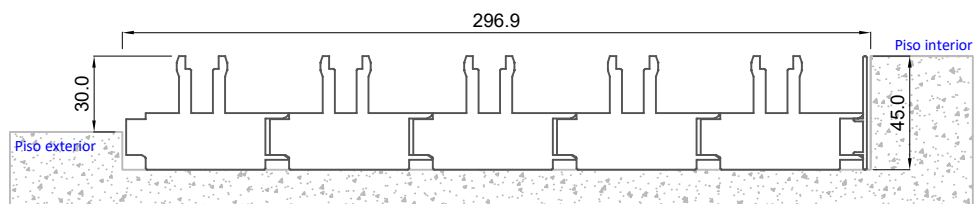

Detalles de cortes de piso

Escala 1:3

Secciones genéricas

ELT y MG - 6 Rieles

Opción #1

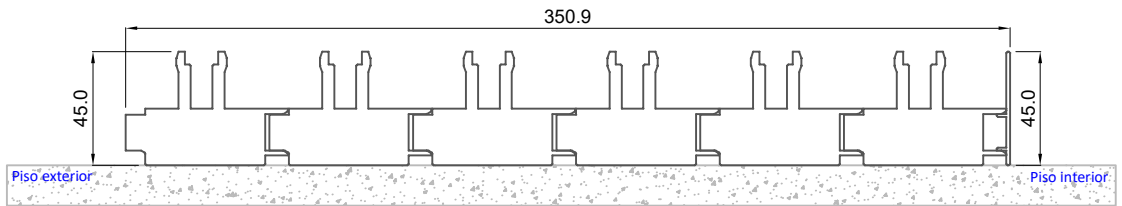

Opción #2

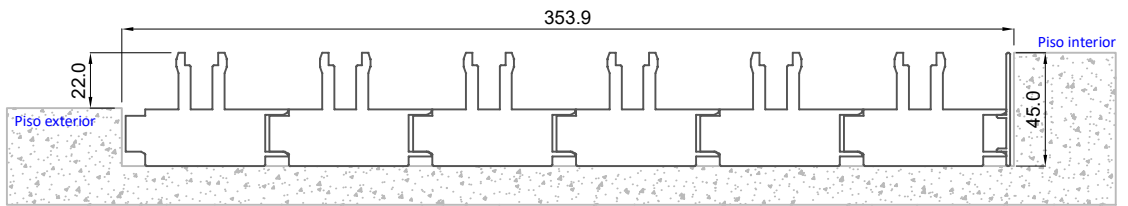

Opción #3

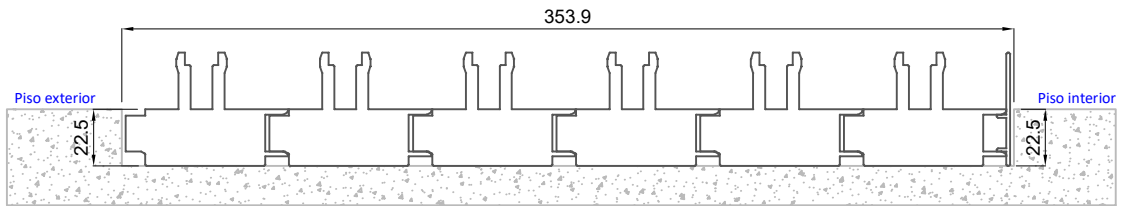

Opción #4

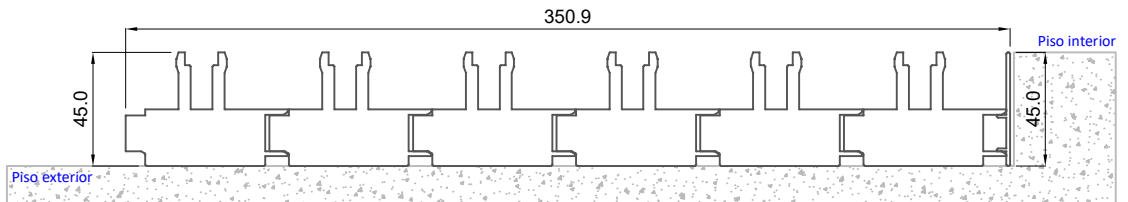

Opción #5

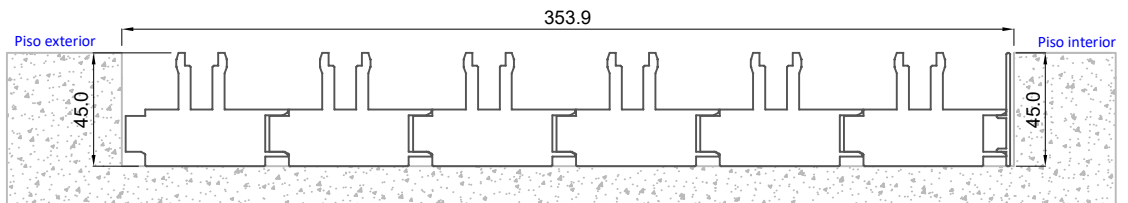

Opción #6

